

Existing Track East Blakeston Lane And Golf Course, Blakeston Lane, Norton
Revised application for proposed vehicular access to course from Blakeston Lane, a 55 no.
space car park, a modular storage building & associated landscaping

Site location Plan and Site Layout Plan (to be amended)

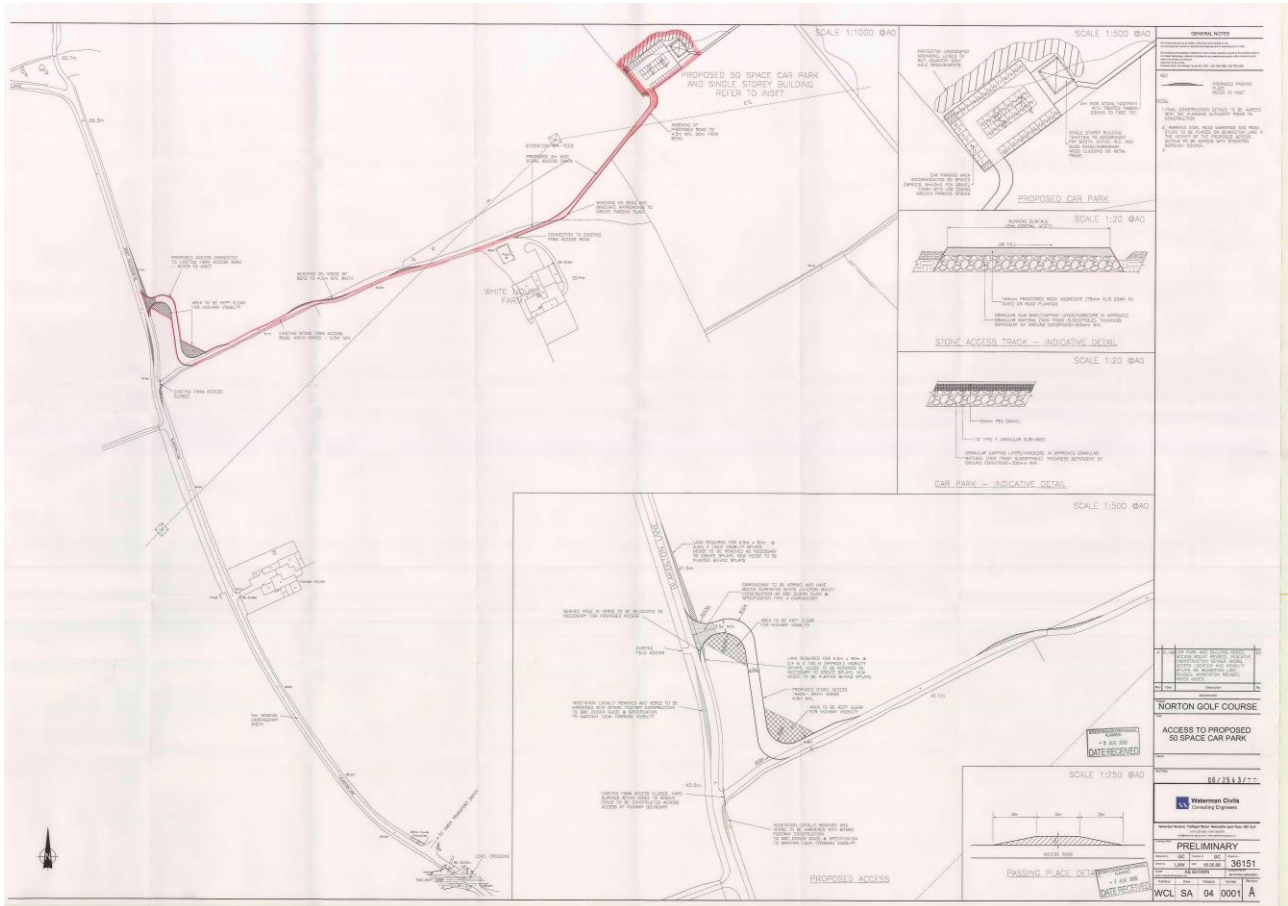

Existing Track East Blakeston Lane And Golf Course, Blakeston Lane, Norton
Revised application for proposed vehicular access to course from Blakeston Lane, a 55 no.
space car park, a modular storage building & associated landscaping

Building Details

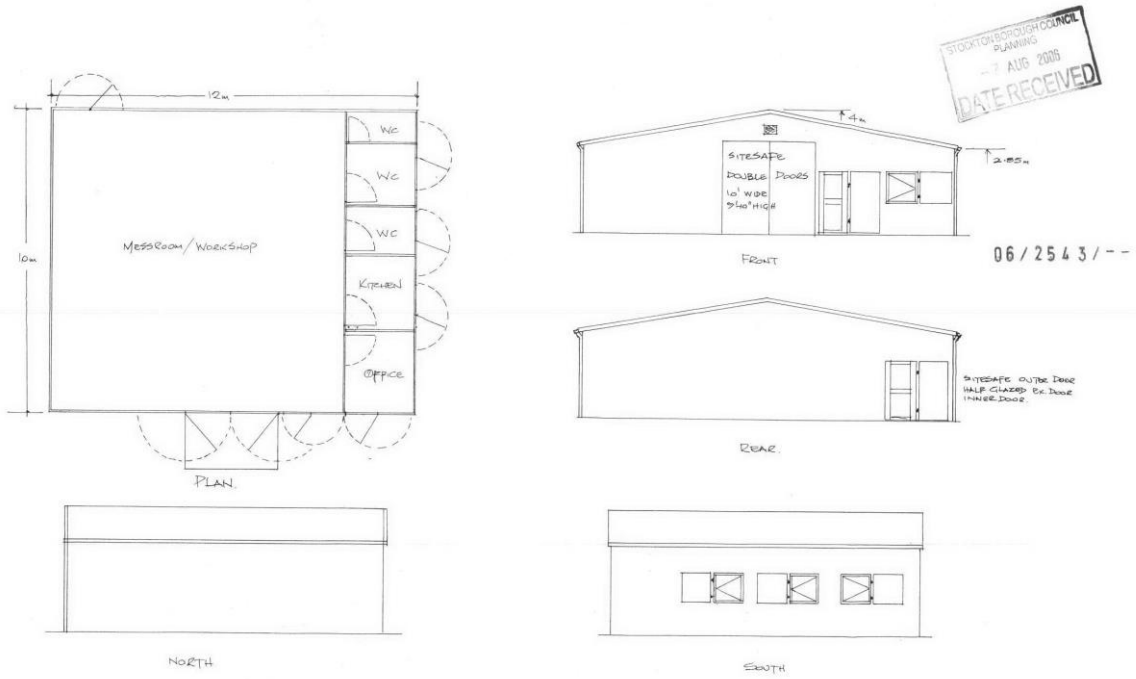

Harpers Golf & Leisure Ltd

Drg No H0111.1/A

Proposed Apex Type Modular Building

Scale 1:100 (A3)